

冷却装置及安装(1.8T) / COOLING SYSTEM(1.8T)

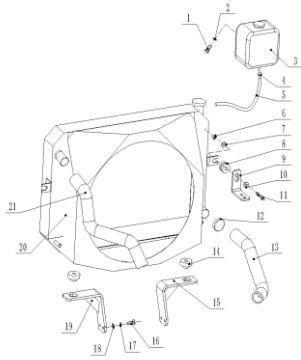

序号/NO	编码/SN	Name	名称	数量/QTY	备注/Remark
A	-	Cooling system	冷却系统	1	
1	910100300010	Bolt M6×16	螺栓M6×16GB/T5783-2000	2	
2	910400500005	Washer 6	垫圈6GB/T93-1987	2	
3	H24C2-10201	Coolant recovery tank	冷却液回收罐	1	
4	911000600008	Hoop d10-16	喉箍d10-16JB/T8870-1999	2	
5	RF035-4-2100006-A0	Rubber pipe Φ8×2-600	橡胶管Φ8×2-600	1	
6	910300500004	Nut M8	螺母M8GB/T889.1-2000	2	
7	910400200003	Washer 8	垫圈8GB/T96.1-2002	2	
8	RF035-4-2100002-A0	Rubber danper B	橡胶垫B	2	
9	F030-D-2100001-A0	Heat sink upper bracket	散热器上支架	2	
9	293060525001	右支架	right bracket	1	k25, GQ-4Y
9	293060525002	左支架	left braceket	1	k25, GQ-4Y
10	910400200005	Washer 12	垫圈12GB/T96.1-2002	2	
11	RF035-4-2100003-A0	Radiator Belt	水箱螺栓	2	
12	911000600015	Hose hoops c27-51	喉箍c27-51JB/T8870-1999	4	
13	F018-D-2100001-A0	Water outlet hose	下水管	1	
13	F018-DX-2100001-A0	Water outlet hose	下水管	1	
13	293060524005	Water outlet hose	下水管	1	K21
14	RF035-4-2100001-A0	Rubber danper A	橡胶垫A	1	
15	F018-D-2101000-A0	Lower left radiator bracket	散热器下支架	1	洋马92
15	F018-DX-2101000-A0	Lower left radiator bracket	散热器下支架	1	新柴4N23
15	293260511005	Lower left radiator bracket	散热器下支架	1	k21
16	910100300020	Bolt M8×16	螺栓M8×16GB/T5783-2000	4	
17	910400500006	Washer 8	垫圈8GB/T93-1987	4	
18	910400100006	Washer 8	垫圈8GB/T97.1-2002	4	
19	F018-D-2101000-A0	Lower left radiator bracket	散热器下支架	1	
19	293260511006	Lower left radiator bracket	散热器下支架	1	
20	F018-D-2102000-A0	radiator assy	散热器总成	1	洋马92
20	F018-DX-2102000-A0	radiator assy	散热器总成	1	新柴4N23
20	293260510005	radiator assy	散热器总成	1	K21
21	RF035-4-2100004-A0	Water inlet hose	上水管	1	洋马92
21	F018-DX-2100002-A0	Water inlet hose	上水管	1	新柴4N23
21	293060524004	Water inlet hose	上水管	1	K21单燃料

驱动桥(1.8T)/ DRIVE AXLE(1.8T)						
序号/NO	编码/SN	Name	名称	数量/QTY	备注/Remark	
A	293098535001	Drive axle	驱动桥Q02A1-03000	1		
1	293298535001	Wheel brake ass'y	左制动器F-3501100-00	1		
2	293298524004	Screw plug	堵塞Z/L/2H-1701104-00	3		
3	293298535002	Drive axle housing	驱动桥壳F-2301101-00	1		
4	293298535003	Half axle	半轴F-2303101-00	2		
5	293298535004	Wheel brake ass'y	右制动器F-3501200-00	1		
6	293298535005	Brake hub	制动鼓F-3103103-00	2		
7	293298535006	Oil seal retainer ring	大油封座圈F-3103102-00	2		
8	910800700001	Oil seal PD100×12×12	油封PD100×125×12GB9877.1-88	2		
9	910700600007	Tapered roller bearing 33012	圆锥滚子轴承30213GB297-84	2		
10	293298535007	Wheel hub	轮毂F-3103101-00	2		
11	293298535008	Brake bolt	轮毂螺栓F-3103106-00	12		
12	293298535009	Nut	轮毂螺母F-3103110-00	12		
13	293298524005	Bolt,half axle	半轴螺栓H-2303107-00	16		
14	910300700005	Round nut M60x2	圆螺母M60×2GB810-88	4		
15	910400900013	Stop washer 60	止动垫圈60GB/T858-88	2		
16	293298535010	Washer,half axle	半轴垫F-2303106-00	2		
17	293098591055	Oil seal PD75×100×10	油封75×100×10GB9877.1-88	2		
18	293298524006	Oil seal retainer ring	小油封座圈H-3103109-00	2		
19	293098591056	O-ring 65×3.1	O型圈D65×3.1GB1253	2		
20	910700600020	bearing 30214	轴承30212GB297-84	2		
21	293298524007	Brake bolt	制动器紧固螺栓H-3501302-00	8		
22	293298524008	Brake bolt	制动器定位螺栓H-3501301-00	4		
23	293298524009	Breather plug ass'y	透气塞H-2301301-00	1		
24	293098591057	O-ring 67×2.65	O型圈67×2.65GB/T3452.1-2005	2		
25	910600100035		圆柱销φ8×20GB119.2	1		

16

驱动轮(1.8T)/DRIVE WHEEL(1.8T)						
序号/NO	编码/SN	Name	名称	数量/QTY	备注/Remark	
A	F018-D-3300000-A0	Front Wheel Ass'y	前轮总成	2		
A	F018-S-0100000-A0	Front Wheel Ass'y - solid tire	前轮总成-实轮胎	2		
1	F018-D-3301001-A0	Rim,outside (5.00F-10)	外轮钢(5.00F-10)	2		
2	F018-D-3301002-A0	Rim,inside (5.00F-10)	内轮钢(5.00F-10)	2		
3	910300100008	Nut M12	螺母M12GB/T6170-2000	12		
4	910400500008	Washer 12	垫圈12GB/T93-1987	12		
5	F020-D-3300001-A0	Rim bolt	轮钢螺栓	12		
6	F030-D-4401000-A0	Tyre ass'y (6.50-10-10PR)	轮胎总成(6.50-10-10PR)	2		

17

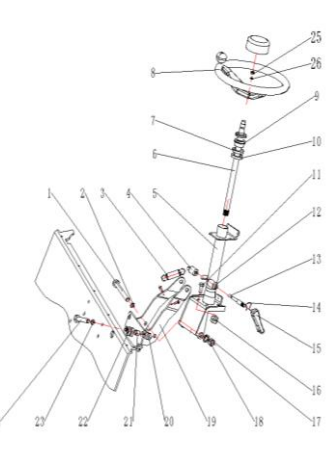
转向装置及安装(1.8T)/STEERING SYSTEM(1.8T)		序号/NO	编码/SN	Name	名称	数量/QTY	备注/Remark
	1	RF025-7-4200003-A0	Bolt	螺栓	2		
	2	RF025-7-4200002-A0	Bushing	衬套	2		
	3	F030-D-4200003-A0	Spring	拉簧	2		
	4	RF025-7-4200001-A0	Block	锁紧块	1		
	5	293215011001	Column ass'y	转向管柱总成	1	包含5-7、9-10	
	6	F030-D-4201001-A0	Steering shaft	转向轴	1		
	7	910401300011	Axial circlip 20	轴用弹性挡圈20GB/T894.1-Φ20	1		
	8	RF035-4-4204000-A0	Steering wheel ass'y Φ300	方向盘总成Φ300	1		
	9	F030-D-4201003-A0	Nylon Bushing	尼龙套	1		
	10	910700200045	Bearing 61904	轴承61904GB/T276-1994-61904	1		
	11	910100300013	Bolt M6×30	螺栓M6×30GB/T5783-M6*30-8.8J	4		
	12	RF025-7-4200004-A0	Cushion	垫块	1		
	13	RF025-7-4200005-A0	Shaft	轴	1		
	14	RF025-7-4200006-A0	Clip	卡扣	1		
	15	RF025-7-4202000-A0	Lock handle	锁紧手柄	1		
	16	910300100005	Nut M6	螺母M6GB/T6170-M6-8J	4		
	17	910300100008	Nut M12	螺母M12GB/T6170-M12	2		
	18	910400500008	Washer 12	垫圈12GB/T93-12	10		
	19	293215012001	Bracket steering column	方向管柱支架	1		
	20	910300100008	Nut M12	螺母M12GB/T6170-M12	4		
	21	F030-D-4200002-A0	Sheeve	隔套	4		
	22	F030-D-4200001-A0	Shock pad A	减震垫A	4		
	23	910400100008	Washer 12	垫圈12GB/T97.1-12	2		
	24	910100300053	Bolt M12×45	螺栓M12×45GB/T5783-M12*45-8.8J	4		
	25	910300400006	Nut M16x1.5	螺母M16x1.5GB/T6173-M16*1.5-8J	1		
	26	910400500010	Washer 16	垫圈16GB/T93-16	1		

18

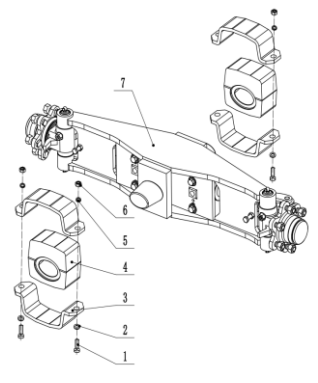
转向桥及安装(1.8T)/STEERING AXLE(1.8T)		序号/NO	编码/SN	Name	名称	数量/QTY	备注/Remark
	1	910100300113	Bolt M16×50	螺栓M16×50GB/T5783-2000	4		
	2	910400100010	Washer 16	垫圈16GB/T97.1-2002	4		
	3	F030-D-6106002-A0	mounting plate	后桥安装板	2		
	4	F030-D-4300001-A0	shock-absorbing pad	转向桥减震垫	2		
	5	910400500010	Washer 16	垫圈16GB/T93-1987	4		
	6	910300100010	Nut M16	螺母M16GB/T6170-2000	4		
	7	F018-D-4301000-A0	self-tracking axle	转向桥总成	1		

19

多路换向阀操纵(四联)(1.8T)/MULTI-WAY VALVE MOUNTS (FOUR-THROW) (1.8T)

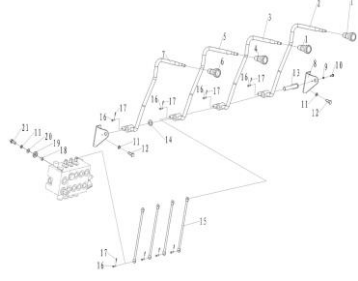

序号/NO	编码/SN	Name	名称	数量/QTY	备注/Remark
01	RF035-4-7403000-A0	4th way valve knob	属具手柄	2	
02	RF035-4-7407000-A0	4th way valve lever	第四联操纵杆	1	
03	RF035-4-7406000-A0	3rd way valve lever	第三联操纵杆	1	
04	RF035-4-7401000-A0	Lift knob	起升手柄	1	
05	RF035-4-7404000-A0	Lift lever	起升操纵杆	1	
06	RF035-4-7402000-A0	Tilt knob	倾斜手柄	1	
07	RF035-4-7405000-A0	Tilt lever	倾斜操纵杆	1	
08	F030-D-7400001-A0	Bracket	支座	2	
09	910400500005	Washer 6	垫圈6GB/T93-1987	1	
10	910100300009	Bolt M6×12	螺栓M6×12GB/T5783-2000	1	
11	910400500007	Washer 10	垫圈10GB/T93-1987	7	
12	910100300035	Bolt M10×20	螺栓M10×20GB/T5783-2000	4	
13	RF035-4-7410000-A0	four-way valve pin shaft	四联销轴	1	
14	RF035-4-7400008-A0	Multi-way valve	多路阀尼龙衬套	按需	
15	RF035-4-7400004-A0	Connecting rod	连接杆	4	
16	RF035-4-7400003-A0	Pin shaft	销轴	8	
17	910600600011	Pin 2×12	销2×12GB/T91-2000	8	
18	RF035-4-7400002-A0	Collar	套管	3	
19	RF035-4-7400001-A0	Rubber danper	橡胶垫	6	
20	910400200004	Washer 10	垫圈10GB/T96.1-2002	3	
21	910400400003	Bolt M10×1.25×25	螺栓M10×1.25×25GB/T5786-2000	3	

变压器油冷系统(1.8T)/TOR-CON OIL COOLING SYSTEM(1.8T)

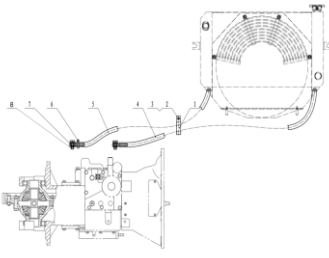

序号/NO	编码/SN	Name	名称	数量/QTY	备注/Remark
A	-	tor-con oil cooling system	变压器油冷却系统	1	
01	951000100012	Clip	管夹	2	
02	910400500005	Washer 6	垫圈6GB/T93-1987	2	
03	910100300009	Bolt M6×12	螺栓M6×12GB/T5783-2000	2	
04	RF035-2-4700002-A0	Tor-con hose φ11×5-1700	变压器油管φ11×5-1700	1	
05	RF035-2-4700003-A0	Tor-con hose φ11×5-1500	变压器油管φ11×5-1500	1	
06	911000600013	Hoop d25	喉箍d25JB/T8870-1999	4	
07	RF035-2-4701000-A0	Connecting bolt	铰接螺栓	2	
08	910800900004	Bonded washer 14	组合垫圈14JB/T982-1977	4	

283398501032门架起升管路(标准门架)/Mast lifting pipeline (standard mast)						
序号/NO	编码/SN	Name	名称	数量/QTY	备注/Remarks	
1	255044020043	Hoop13	扎带(带扣)P-N156-00646	5		
2	255044020042	Press plate	扎带4x250	8		
3	921600400001	Strip 4x250	压板	8		
4	▲	Hose 13x1.5/PE	软管13x1.5/PE	1.7m		
	▲	Hose 13x1.5/PE	软管13x1.5/PE	1.9m		
	▲	Hose 13x1.5/PE	软管13x1.5/PE	2.2m		
	▲	Hose 13x1.5/PE	软管13x1.5/PE	2.5m		
	▲	Hose 13x1.5/PE	软管13x1.5/PE	2.7m		
	▲	Hose 13x1.5/PE	软管13x1.5/PE	2.9m		
	▲	Hose 13x1.5/PE	软管13x1.5/PE	3.3m		
	▲	Hose 13x1.5/PE	软管13x1.5/PE	3.6m		
4	▲	Hose 13x1.5/PE	软管13x1.5/PE	3.8m		
4	▲	Hose 13x1.5/PE	软管13x1.5/PE	4.3m		
5	921600400003	Strip P-N156-00646	扎带(带扣)P-N156-00646	3		
6	251223520030	Joint 15-M22x1.5-M22x1.5-24°	接头(直)15-M22x1.5-M22x1.5-24°	1		
7	283323520001	Hydraulic hose assembly 15-L700-2SC-24°	液压管总成(异)15-L700-2SC-24°	1		
8	▲	O - inner	O形圈	4	接头自带	
9	251244019001	Joint-24°	接头(三通)-24°	1		
10	251244529001	Hydraulic hose assembly 10-L360-2SC-24°	液压管总成(直)10-L360-2SC-24°	1		
11	251244029002	60L stop valve	60L切断阀	1		
12	255044020118	Joint	接头(三通)	1		

44

283398501033起升油缸(标准门架)/Lifting cylinder(standard mast)						
序号/NO	编码/SN	Name	名称	数量/QTY	备注/Remarks	
1	940200500003	Chain wheel bearing780708K-φ110xφ40x27	链轮轴承780706-φ72xφ30x21	2		
2	910401300020	Cir clip GB894.1-40	轴用弹性挡圈GB894.1-40	2		
3	910100300051	Bolt GB5786-M16x1.5x40-8.8	螺栓GB5783-M12x35-8.8	2		
4	910400500008	Spring washer GB93-12	弹簧垫圈GB93-12	2		
5	254144010021	Cylinder (H=2000)	油缸(H=2500)	2	H=2500	
	254144010022	Cylinder (H=2500)	油缸(H=2700)	2	H=2700	
	254144010023	Cylinder (H=3000)	油缸(H=3000)	2	H=3000	
	254144010024	Cylinder (H=3300)	油缸(H=3300)	2	H=3300	
	254144010025	Cylinder (H=3500)	油缸(H=3500)	2	H=3500	
	254144010026	Cylinder (H=3600)	油缸(H=3700)	2	H=3700	
	254144010027	Cylinder (H=3700)	油缸(H=4000)	2	H=4000	
	254144010028	Cylinder (H=4000)	油缸(H=4300)	2	H=4300	
	254144010029	Cylinder (H=4300)	油缸(H=4500)	2	H=4500	
254144010030	Cylinder (H=4500)	油缸(H=5000)	2	H=5000		
6	▲	Split pin 2.5x40	开口销 2x32	2		
7	▲	LH1623 chain	LH1223板式链	2		
8	▲	Joint	长端接头	2		
9	▲	Split pin 3.2x30	开口销 3.2x30	2		
10	▲	Nut M16x1.5	螺母M16x1.5	2		
11	▲	Nut M18x1.5	球面螺母M16x1.5	2		
12	254144020060	Fixing ring	固定环	2		
13	254144020061	Rubber bushing	防护罩	2		
14	254144020062	Fixing seat	固定座	2		
15	910400100006	Washer GB97.1-8-200HV	平垫圈GB97.1-8-200HV	4		
16	910400500006	Spring washer GB93-8	弹簧垫圈GB93-8	4		
17	910300100006	Nut GB6170-M8-10	螺母GB6170-M8-10	4		
18	910300100007	Nut GB6170-M10-10	螺母GB6170-M10-10	2		
19	910100300038	Bolt GB5783-M10x35-8.8	螺栓GB5783-M10x35-8.8	2		
20	▲	Joint	短端接头	2		
21	910400500007	Spring washer GB93-10	弹簧垫圈GB93-10	6		
22	910100400002	Bolt GB5786-M10x1.25x20-8.8	螺栓GB5786-M10x1.25x20-8.8	2		

45

283398501033起升油缸(标准门架)/Lifting cylinder(standard mast)					
序号/NO	编码/SN	Name	名称	数量/QTY	备注/Remarks
23	▲	Piston rod	活塞杆	1	
24	▲	Adjusting bushing φ35.5xφ44xL1	调整套φ35.5xφ44xL1	1	
25	▲	Cir clip	钢丝挡圈	1	
26	▲	Bearing D45x8(t=2.5)	支承环D45x8(t=2.5)	1	
27	▲	Catch 35x45x3	挡片35x45x3	1	
28	▲	Seal ring 45x35x6	孔用密封圈4	1	
29	▲	Piston rod	活塞	1	
30	▲	Copper bushing	铜套	1	
31	▲	Cir clip	钢丝挡圈	1	
32	▲	Buffering ring 35x47x7	防尘圈	1	
33	▲	Dust ring35x45x6	轴用密封圈	1	
34	▲	Guide sleeve	导向套	1	
35	▲	O ring 44.7x2.4	O型密封圈	1	
36	▲	Bearing 3530	钢背轴承3530	1	
37	▲	Cylinder	缸体	1	
A	254198510001	Dowel pin	密封件修理包(起升缸)	2	包管 /loc. 27,29,34,25,27
B	251244014002	Lifting chain LH1234-93	起升链条LH1234-93	2	H=2500
	252144014011	Lifting chain LH1234-99	起升链条LH1234-99	2	H=2700
	252144014012	Lifting chain LH1234-107	起升链条LH1234-107	2	H=3000
	251244514005	Lifting chain LH1234-115	起升链条LH1234-115	2	H=3300
	251244014006	Lifting chain LH1234-119	起升链条LH1234-119	2	H=3500
	251244514006	Lifting chain LH1234-125	起升链条LH1234-125	2	H=3700
	251244014008	Lifting chain LH1234-149	起升链条LH1234-149	2	H=4000
	252144014017	Lifting chain LH1234-151	起升链条LH1234-151	2	H=4300
	252144014009	Lifting chain LH1234-161	起升链条LH1234-161	2	H=4500
	252144014018	Lifting chain LH1234-177	起升链条LH1234-177	2	H=5000

46

283398501034单附加(标准门架)/Side shifter and pipeline installation (standard mast)					
序号/NO	编码/SN	Name	名称	数量/QTY	备注/Remarks
1	255044520081	bushing	衬套	2	
2	251127520001	Pulley Φ110x42(double groove)	滑轮Φ110x42(双槽)	2	
3	910400200005	big washer GB96.1-12-200HV	大垫圈GB96.1-12-200HV	2	
4	910400500008	Spring washer GB93-12	弹簧垫圈GB93-12	2	
5	910100300054	Bolt GB5783-M12x50-8.8	螺栓GB5783-M12x50-8.8	2	
6	283344021003	mounting plate	安装板	1	
7	910100300025	Bolt GB5783-M8x35-8.8	螺栓GB5783-M8x35-8.8	4	
8	910400500006	Spring washer GB93-8	弹簧垫圈GB93-8	12	
9	910400100006	Flat washer GB97.1-8-200HV	平垫圈GB97.1-8-200HV	12	
10	255028520034	Pipe press fixedly plank	胶管固定块	8	
11	255028520035	mounting plate	安装板(管夹)	4	
12	251328020002	Hydraulic hose assembly10-L3600-1SC-24°	液压管总成(直)10-L3750-1SC-24°	2	H=2500
	251327520003	Hydraulic hose assembly10-L3700-1SC-24°	液压管总成(直)10-L3900-1SC-24°	2	H=2700
	251328020003	Hydraulic hose assembly10-L4000-1SC-24°	液压管总成(直)10-L4150-1SC-24°	2	H=3000
	251328020005	Hydraulic hose assembly10-L4400-1SC-24°	液压管总成(直)10-L4550-1SC-24°	2	H=3300
	283327520011	Hydraulic hose assembly10-L4500-1SC-24°	液压管总成(直)10-L4680-1SC-24°	2	H=3500
	283327520012	Hydraulic hose assembly10-L4700-1SC-24°	液压管总成(直)10-L4880-1SC-24°	2	H=3700
	283327520013	Hydraulic hose assembly10-L5075-1SC-24°	液压管总成(直)10-L5280-1SC-24°	2	H=4000
	283327520014	Hydraulic hose assembly10-L5400-1SC-24°	液压管总成(直)10-L5580-1SC-24°	2	H=4300
283327520015	Hydraulic hose assembly10-L5700-1SC-24°	液压管总成(直)10-L5880-1SC-24°	2	H=4500	
283327520016	Hydraulic hose assembly10-L6150-1SC-24°	液压管总成(直)10-L6330-1SC-24°	2	H=5000	
13	251230520010	Joint (locking bend) 8-2xM16x1.5-24°	接头(锁定弯)8-2xM16x1.5-24°	4	
14	254127520001	mounting plate	安装板	2	
15	910200200055	Screw GB70.1-M8x16-8.8	螺钉GB70.1-M8x16-8.8	8	
16	254142520001	Hydraulic hose assembly (90°)10-L300-1SC-	液压管总成(90°)10-L300-1SC-60°-0°	2	
17	910800100001	Oring 9.5x1.8	O形圈-内9.5x1.8	2	
18	255042510004	Side shifter assembly(LH)	侧移器总成(LH)	1	选装/optional
	255042510001	Side shifter assembly(LD)	侧移器总成(LD)	1	选装/optional
	255042510002	Side shifter assembly(CASCADE)	侧移器总成(卡斯卡特)	1	选装/optional

47

283398501035双附加管路 (标准门架) / FOURTH ADDITIONAL PIPELINE (standard mast)						
序号/NO	编码/SN	Name	名称	数量/QTY	备注/Remarks	
1	255044520081	bushing	衬套	2		
2	251127520001	Pulley Φ110x42(double groove)	滑轮Φ110x42(双槽)	2		
3	910400200005	big washer GB96.1-12-200HV	大垫圈GB96.1-12-200HV	2		
4	910400500008	Spring washer GB93-12	弹簧垫圈GB93-12	2		
5	9101003000054	Bolt GB5783-M12x50-8.8	螺栓GB5783-M12x50-8.8	2		
6	283344021004	mounting plate	安装板	1		
7	9101003000025	Bolt GB5783-M8x35-8.8	螺栓GB5783-M8x35-8.8	4		
8	9104005000006	Spring washer GB93-8	弹簧垫圈GB93-8	12		
9	910400100006	Flat washer GB97.1-8-200HV	平垫圈GB97.1-8-200HV	12		
10	255028520034	Pipe press fixedly plank	胶管固定块	8		
11	255028520035	mounting plate	安装板(管夹)	4	H=2500	
12	282331020103	Hydraulic hose assembly10-L3600-1SC-24°	液压管总成(直)10-L3600-1SC-24°	2	H=2700	
	283328020011	Hydraulic hose assembly10-L3700-1SC-24°	液压管总成(直)10-L4080-1SC-24°	2	H=3000	
	283328020012	Hydraulic hose assembly10-L4000-1SC-24°	液压管总成(直)10-L4380-1SC-24°	2	H=3300	
	282331020107	Hydraulic hose assembly10-L4400-1SC-24°	液压管总成(直)10-L4770-1SC-24°	2	H=3500	
	283328020013	Hydraulic hose assembly10-L4500-1SC-24°	液压管总成(直)10-L4870-1SC-24°	2	H=3700	
	251228020006	Hydraulic hose assembly10-L4700-1SC-24°	液压管总成(直)10-L4700-1SC-24°	2	H=4000	
	251228020007	Hydraulic hose assembly10-L5075-1SC-24°	液压管总成(直)10-L5075-1SC-24°	2	H=4300	
	251328020009	Hydraulic hose assembly10-L5400-1SC-24°	液压管总成(直)10-L5750-1SC-24°	2	H=4500	
	251327520010	Hydraulic hose assembly10-L5700-1SC-24°	液压管总成(直)10-L6050-1SC-24°	2	H=5000	
	283328020014	Hydraulic hose assembly10-L6150-1SC-24°	液压管总成(直)10-L6500-1SC-24°	2		
13	251230520010	Joint (locking bend) 8-2xM16x1.5-24°	接头(锁定弯)8-2xM16x1.5-24°	4		
14	254127520001	mounting plate	安装板	2		
15	9102002000055	Screw GB70.1-M8x16-8.8	螺钉GB70.1-M8x16-8.8	8		

48

293298501036门架(三级全自由)/Mast (three stage full free)						
序号/NO	编码/SN	Name	名称	数量/QTY	备注/Remarks	
1	282344512001	Inner (mast)4000	内门架焊合(4000)	1	H=4000	
	282344512002	Inner (mast)4350	内门架焊合(4350)	1	H=4350	
	282344512003	Inner (mast)4500	内门架焊合(4500)	1	H=4500	
	282344512004	Inner (mast)4800	内门架焊合(4800)	1	H=4800	
	282344512005	Inner (mast)5000	内门架焊合(5000)	1	H=5000	
	282344512006	Inner (mast) 5500	内门架焊合(5500)	1	H=5500	
2	282344512007	Inner (mast) 6000	内门架焊合(6000)	1	H=6000	
	293244513001	Middle mast (4350)	中门架焊合(4000)	1	H=4000	
	293244513002	Middle mast (4350)	中门架焊合(4350)	1	H=4350	
	293244513003	Middle mast (4500)	中门架焊合(4500)	1	H=4500	
	293244513004	Middle mast (5000)	中门架焊合(5000)	1	H=5000	
	293244513005	Middle mast (4800)	中门架焊合(4800)	1	H=4800	
	293244513006	Middle mast (5500)	中门架焊合(5500)	1	H=5500	
	293244513007	Middle mast (6000)	中门架焊合(6000)	1	H=6000	
3	940200300047	Composite roller Φ 78.8 = 45.3-49.3	复合滚轮Φ78.8-range=45.3-49.3	6	Option	
	940200300048	Composite roller Φ 79.1 = 45.3-49.3	复合滚轮Φ79.1-range=45.3-49.3	6	Option	
	940200300033	Composite roller Φ 79.4 = 45.3-49.3	复合滚轮Φ79.4-range=45.3-49.3	6	Option	
4	910401300018	Circlip GB894.1-35	轴用弹性挡圈GB894.1-35	6		
5	293244511001	Outer mast (4350)	外门架焊合(4000)	1	H=4000	
	293244511002	Outer mast (4350)	外门架焊合(4350)	1	H=4350	
	293244511003	Outer mast (4500)	外门架焊合(4500)	1	H=4500	
	293244511004	Outer mast (4800)	外门架焊合(4800)	1	H=4800	
	293244511005	Outer mast (5000)	外门架焊合(5000)	1	H=5000	
	293244511006	Outer mast (5500)	外门架焊合(5500)	1	H=5500	
	293244511007	Outer mast (6000)	外门架焊合(6000)	1	H=6000	
6	293220502001	Tilted cylinder	倾斜油缸	2		
7	940500499003	wear-proof casing Φ38xΦ30x25	自润滑轴承Φ38xΦ30x25	2		
8	255044010056	Axle Φ30x72	带耳轴Φ30x72	2		
9	9104005000006	Washer GB93-8	弹簧垫圈GB93-8	2		
10	9101003000022	Bolt GB5783-M8x20-8.8	螺栓GB5783-M8x20-8.8	2		
11	9101002000016	Bolt GB5785-M16x1.5x70-8.8	螺栓GB5785-M16x1.5x70-8.8	4		
12	9104005000010	Washer GB93-16	弹簧垫圈GB93-16	4		
13	256844021014	Bearing cover	支座盖	2		
14	254144020063	Bearing bush	轴瓦	2		

49

283398501037货叉架 (三级全自由) /Fork carrier(three stage full free)

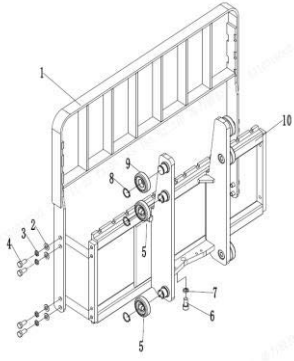

序号/NO	编码/SN	Name	名称	数量/QTY	备注/Remarks
1	255040510001	Load backrest welding	挡货架焊接(1040x986)	1	
2	910400100009	Washer GB97.1-14-200HV	平垫圈GB97.1-14-200HV	8	
3	910400500009	Washer GB93-14	弹簧垫圈GB93-14	8	
4	910100300062	Bolt GB5783-M14x30-8.8	螺栓GB5783-M14x30-8.8	8	
5	940200100082	Composite roller Φ 78.8 = 52.5-56.5	复合滚轮 Φ 78.8-range=52.5-56.5(外圈斜1°)	4	
	940200300050	Composite roller Φ 79.1 = 52.5-56.5	复合滚轮 Φ 79.10-range=52.5-56.5(外圈斜1°)	4	
	940200300032	Composite roller Φ 79.4 = 52.5-56.5	复合滚轮 Φ 79.4-range=52.5-56.5(外圈斜1°)	4	
6	910200200119	Screw GB70.1 M16x30-8.8	螺钉GB70.1-M16x30-8.8	1	
7	910400500010	Washer GB93-16	弹簧垫圈GB93-16	1	
8	910401300018	Circlip GB894.1-35	轴用弹性挡圈GB894.1-35	6	
9	940200100043	Main roller Φ 78.80 x Φ 35 x22.5	主滚轮 Φ 78.80x Φ 35x22.5(外圈斜1°)	2	
	940200100044	Main roller Φ 79.1 x Φ 35 x22.5	主滚轮 Φ 79.1x Φ 35x22.5(外圈斜1°)	2	
	940200100039	Main roller Φ 79.4 x Φ 35 x22.5	主滚轮 Φ 79.4x Φ 35x22.5(外圈斜1°)	2	
10	283338013002	Fork carrier weldind (sthree stage full free)	货叉架焊接A(三级全自由门架)	1	

50

293298501038门架起升管路 (三级全自由)/Mast lifting pipeline(three stage full free lift)

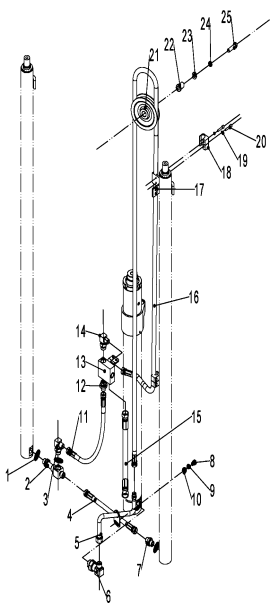

序号/NO	编码/SN	Name	名称	数量/QTY	备注/Remarks
1	▲	O - inner	O形圈	4	
2	251244019001	joint)-24°	接头(三通)-24°	1	
3	282344529001	Connector (lock bend)10-M18x1.5-M22x1.5-	接头(锁定弯)10-M18x1.5-M22x1.5-24°	1	
4	282344529004	Hydraulic hose assembly 12-L305-2SC-24°	液压管总成(直)12-L305-2SC-24°	1	
5	282344519001	The transition pipe(24°)	中缸过渡钢管焊合(24°)	1	
6	251244529002	joint12-M27x2-M22x1.5-24°	接头(锁定弯)12-M27x2-M22x1.5-24°	1	
7				1	
8	910100300020	BoltGB5783-M8x16-8.8	螺栓GB5783-M8x16-8.8	4	
9	910400100006	The flat washer GB97.1-8-200HV	平垫圈GB97.1-8-200HV	6	
10	910400500006	Spring washerGB93-8	弹簧垫圈GB93-8	4	
11	283344529003	Hydraulic hose assembly (135 °)15-L730-	液压管总成(135°)15-L730-2SC-24°	1	
12	201025020019	Connector 22-M22x1.5-M18x1.5-24°	接头(直)22-M22x1.5-M18x1.5-24°	3	
13	252144519002	Tee welded(20Q)	三通焊合(20Q)	1	
14	282344529001	Connector 10-M18x1.5-M22x1.5-24°	接头(锁定弯)10-M18x1.5-M22x1.5-24°	1	
15	282344529003	Hydraulic hose assembly 15-L450-2SC-24°	液压管总成(直)15-L450-2SC-24°	1	
16	282344529501	Hydraulic hose assembly 12-L2800-2SC-24°	液压管总成(直) 12-L2800-2SC-24°	1	H=4000
	282344529502	Hydraulic hose assembly 15-L3050-2SC-24°	液压管总成(直) 12-L3050-2SC-24°	1	H=4350
	251244529502	Hydraulic hose assembly 15-L3150-2SC-24°	液压管总成(直) 12-L3150-2SC-24°	1	H=4500
	282344529503	Hydraulic hose assembly 15-L3350-2SC-24°	液压管总成(直) 12-L3350-2SC-24°	1	H=4800
	282344529504	Hydraulic hose assembly 15-L3550-2SC-24°	液压管总成(直) 12-L3550-2SC-24°	1	H=5000
	282344529505	Hydraulic hose assembly 15-L3850-2SC-24°	液压管总成(直) 12-L3850-2SC-24°	1	H=5500
17	282344529002	Support	支架	1	
18	255044520132	Tubing clamps	油管夹	2	
19	910400100005	Flat washer GB97.1-6-200 HV	平垫圈GB97.1-6-200HV	2	
20	910200200035	Screw GB70.1 M6x16-8.8	螺钉GB70.1-M6x16-8.8	2	
21	255030520021	Pulley Φ 110x27(single groove)	滑轮 Φ 110x27(单槽)	2	
22	255030520022	Bushing Φ 20x Φ 13 x 56	衬套 Φ 20x Φ 13x56	1	
23	910400500008	Spring washer GB93-12	弹簧垫圈GB93-12	2	
24	910400100008	flat washer GB97.1-12-200 hv	平垫圈GB97.1-12-200HV	2	
25	910100100054	Bolt GB5782 M12x80-8.8	螺栓GB5782-M12x80-8.8	2	

51

283398501039短升降油缸 (三級全自由) /Short lifting cylinder (three stage full free)						
序号/NO	編碼/SN	Name	名称	数量/QTY	备注/Remarks	
1	254144510014	Lifting chain LH1266-69	起升链条LH1266-69	2	H=4000	
2	254143510061	Lifting chain LH1266-71	起升链条LH1266-71	2	H=4350	
3	254144510015	Lifting chain LH1266-73	起升链条LH1266-73	2	H=4500	
4	254144510016	Lifting chain LH1266-75	起升链条LH1266-75	2	H=4800	
5	254144510017	Lifting chain LH1266-77	起升链条LH1266-77	2	H=5000	
6	254144510018	Lifting chain LH1266-83	起升链条LH1266-83	2	H=5500	
7	254144510019	Lifting chain LH1266-89	起升链条LH1266-89	2	H=6000	
8	▲	Dust ring 50x58x7/6.5	防尘圈50x58x7/6.5	1		
9	▲	Catch 50x60x3	挡片50x60x3	1		
10	▲	Seal ring 50x60x6	密封圈50x60x6	1		
11	▲	Glide sleeve	导向套	1		
12	▲	O ring D75X3.1	O型密封圈D75X3.1	1		
13	▲	O ring D75X3.1	O型密封圈D70x3.1	1		
14	▲	Bearing50x55x40	钢背轴承 50x55x40	1		
15	▲	HSG Piston rod	HSG活塞杆	1		
16	▲	Circlip	钢丝挡圈	1		
17	▲	Piston assembly	活塞总成	1		
18	▲	Support ring 65x70x20	支承环65x70x20	1		
19	▲	Seal ring 70x60x6	孔用密封圈70x60x6	1		
20	▲	Valve cover	阀套	1		
21	▲	O ring D15x2.4	O型密封圈D15x2.4	1		
22	▲	Valve plug	阀芯	1		
23	▲	Catch	挡片	1		
24	▲	Circlip 22(inport)	挡圈 22(进口型)	1		
25	▲	Slide valve	滑阀	1		
26	▲	Spring2.3x15x48.5	弹簧2.3x15x48.5	1		
27	▲	Cylinder	缸体	1		
28	▲	Spacer	垫片	1		
29	▲	Screw M5x5	螺钉M5x5	1		
30	910600600019	Split pin 2.5x25	开口销GB91-2.5x25	2		
31	910900400013	LH1266 chain	LH1266板式链	2		

52

283398501039短升降油缸 (三級全自由) /Short lifting cylinder (three stage full free)						
序号/NO	編碼/SN	Name	名称	数量/QTY	备注/Remarks	
32	254143520073	Pin Φ x54.5 7.94	销轴Φ7.94x54.5	2		
33	254143520070	Joint	长端接头	2		
34	910600600032	split pin3.2x40	开口销3.2x40	2		
35	255044020158	Nut M18x1.5	球面螺母M18x1.5	2		
36	254143520070	Nut M18x1.5	螺母M18x1.5	2		
37	254143520071	Joint	短端接头	1		
38	275243520072	Hydro cylinder fixed loop	油缸固定环	2		
39	910400500006	Spring Washer GB93-8	弹簧垫圈GB93-8	2		
40	910300100006	Bolt GB6170-M8-10	螺母GB6170-M8-10	1		
41	254144510030	Short lifting cylinder H=4000	油缸(M)(H=4000)	1	H=4000	
42	254143510102	Short lifting cylinder H=4350	油缸(M)(H=4350)	1	H=4350	
43	254144510032	Short lifting cylinder H=4500	油缸(M)(H=4500)	1	H=4500	
44	254144502013	Short lifting cylinder H=4800	油缸(M)(H=4800)	1	H=4800	
45	254143510104	Short lifting cylinder H=5000	油缸(M)(H=5000)	1	H=5000	
46	254144510035	Short lifting cylinder H=5500	油缸(M)(H=5500)	1	H=5500	
47	254144510036	Short lifting cylinder H=6000	油缸(M)(H=6000)	1	H=6000	
48	910400500008	SpringWasherGB93-12	弹簧垫圈GB93-12	1		
49	910100400009	BoltGB5786-M12x1.25x25-8.8	螺栓GB5786-M12x1.25x25-8.8	1		
B	254198510005	Seal kits (three stage full free lifting cylinder)	密封件修理包(中间缸)	1	包含Inc.1.3.5.6.13.18	

53

283398501040起升油缸(三级全自由)/Lifting cylinder(three stage full free)					
序号/NO	编码/SN	Name	名称	数量/QTY	备注/Remarks
1	254144520093	Hoop(inner)	内抱箍(内)	2	
2	254144520092	Hoop(outer)	内抱箍(外)	2	
3	910400100007	Washer GB97.1-10-200HV	平垫圈GB97.1-10-200HV	4	
4	910400500007	Washer GB93-10	弹簧垫圈GB93-10	4	
5	910100300037	Bolt GB5783 M10x30-8.8	螺栓GB5783-M10x30-8.8	4	
6	910400100008	Washer GB97.1-12-200HV	平垫圈GB97.1-12-200HV	2	
7	910400500008	Washer GB93-12	弹簧垫圈GB93-12	4	
8	910100400009	Bolt GB5786-M12x1.25x25-8.8	螺栓GB5786-M12x1.25x25-8.8	2	
9	910100300053	Bolt GB5783-M12x45-8.8	螺栓GB5783-M12x45-8.8	2	
10	910401300020	Circlip GB894.1-40	轴用弹性挡圈GB894.1-40	2	
11	940200500015	Chain wheel bearing 780708K3-Φ95xΦ40x27	链轮轴承780708K3-Φ95xΦ40x27	2	
12	910900400010	LH1234 chain	板式链GB6074-LH1234	2	
13	910600600047	Split pin 3.2x30	开口销GB91-2x30	2	
14	252043520037	Chain pin Φ7.84x35.1	销轴Φ7.84x35.1	2	
15	252044020121	Chain bolt M16x1.5-178	链条螺栓M16x1.5x178	2	
16	910600600030	Split pin 3.2x30	开口销GB91-3.2x30	2	
17	254144020066	Nut M16x1.5	螺母M16x1.5	2	
18	910300200002	Nut GB6171 - M10x1.25-10	螺母GB6171-M10x1.25-10	1	
19	252044020120	Chain bolt M16x1.5-95	链条螺栓M16x1.5x95	1	
20	▲	Piston rod	活塞杆	1	
21	▲	Adjusting bushing 35.5x44xL1	调整套35.5x44xL1	1	
22	▲	Circlip	钢丝挡圈	1	
23	▲	41 x45x8 bearing ring	支承环41x45x8	1	
24	▲	Seal ring 45x35x6	孔用密封圈	1	
25	▲	35 x45x3 block slice	挡片35x45x3	1	
26	▲	Piston	活塞	1	
27	▲	Copper bushing	铜套	1	
28	▲	Circlip	钢丝挡圈	1	
29	▲	Buffer ring	缓冲环	1	
30	▲	Anti-explosion valve	防爆阀	1	
31	▲	Dust ring	防尘圈DH35X43X6.5	1	

54

283398501040起升油缸(三级全自由)/Lifting cylinder(three stage full free)					
序号/NO	编码/SN	Name	名称	数量/QTY	备注/Remarks
32	▲	Seal ring	轴用密封圈35X45X6	1	
33	▲	Guide bushing	导向套	1	
34	▲	O seal ring	O型密封圈	1	
35	▲	Bearing 3530	钢背轴承3530	1	
36	▲	Cylinder	缸体	1	
A	252044510006	Lifting chain LH1234-95	起升链条LH1234-95	2	H=4000
	251244014003	Lifting chain LH1234-101	起升链条LH1234-101	2	H=4350
	252144014003	Lifting chain LH1234-105	起升链条LH1234-105	2	H=4500
	251244014004	Lifting chain LH1234-109	起升链条LH1234-109	2	H=4800
	251244514005	Lifting chain LH1234-115	起升链条LH1234-115	2	H=5000
	252144014002	Lifting chain LH1234-123	起升链条LH1234-123	2	H=5500
B	252144014006	Lifting chain LH1234-133	起升链条LH1234-133	2	H=6000
	254144510051	Right lifting cylinder H=4000	油缸(R)(H=4000)	1	H=4000
	254144510052	Right lifting cylinder H=4300	油缸(R)(H=4350)	1	H=4350
	254144510053	Right lifting cylinder H=4500	油缸(R)(H=4500)	1	H=4500
	254144510054	Right lifting cylinder H=4800	油缸(R)(H=4800)	1	H=4800
	254144510055	Right lifting cylinder H=5000	油缸(R)(H=5000)	1	H=5000
C	254144510056	Right lifting cylinder H=5500	油缸(R)(H=5500)	1	H=5500
	254144510057	Right lifting cylinder H=6000	油缸(R)(H=6000)	1	H=6000
	251244516001	Left lifting cylinder H=4000	油缸(L)(H=4000)	1	H=4000
	251244516002	Left lifting cylinder H=4350	油缸(L)(H=4350)	1	H=4350
	251244516003	Left lifting cylinder H=4500	油缸(L)(H=4500)	1	H=4500
	251244516004	Left lifting cylinder H=4800	油缸(L)(H=4800)	1	H=4800
D	251244516005	Left lifting cylinder H=5000	油缸(L)(H=5000)	1	H=5000
	251244516006	Left lifting cylinder H=5500	油缸(L)(H=5500)	1	H=5500
	251244516007	Left lifting cylinder H=6000	油缸(L)(H=6000)	1	H=6000
	254198510003	Seal kits(three stage full free lifting cylinder)	密封件修理包(三级全自由起升缸)	1	

55

